



**SPOSEN**  
SIGNATURE HOMES  
INTEGRITY • QUALITY • VALUE

# *The Key West*



The Modern Elevation



The Coastal Elevation



The Transitional Elevation



**Living: 2247 sq ft**  
**Total: 2863 sq ft**  
 5 Bedroom - 3 Bath  
 2 Car Garage

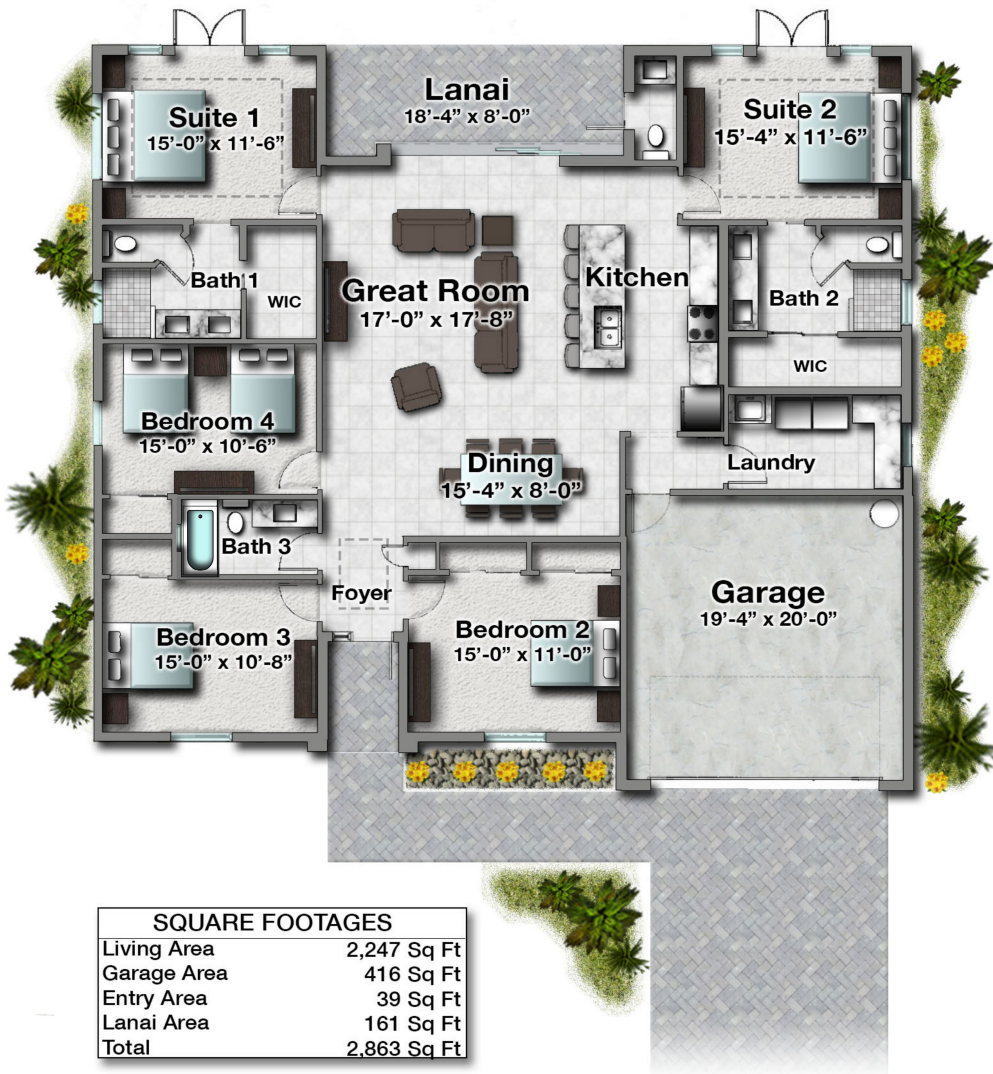

### Exterior Features

- Concrete Construction with Stucco Finish
- Dimensional Shingles
- Aluminum Soffit & Fascia
- Decorative Paver Driveway, Walkway & Lanai
- Full Landscaping Package
- Automated Sprinkler System

### Interior Features

- Grand Ceilings with Decorative Trays
- Designer Cabinet Options
- Granite Countertops
- Moen Plumbing Features
- Stainless Steel Appliances
- Flooring Package Options

### Allowances For

- Permit Fees
- Impact Fees
- Fill Dirt

Please consult your new home specialist to confirm specific standard features and options available per model as the front elevation and floor plan information shown including pricing, standard features and options may vary from shown. All pricing, standards and options are subject to change at any time without notice or obligation. Drawings, pictures, square footages, floor plans, elevations, features, colors and sizes are approximate for illustration purposes only and will vary from the homes as built.

Color renderings are for artistic purpose only and do not necessarily represent actual color choices or options for interior and/or exterior of model. Artistic renderings are subject to change or refinement over time, square footage totals have been calculated using the engineering method (legal boundaries of the unit) and are subject to change upon final architectural drawings. Home prices refer to the base price of the model and include the vertical construction costs and posted site specific allowances only. Base prices do not include a build-able lot, options, pool packages and/or site specific allowance adjustments unless otherwise indicated. All rights reserved. ©2020 Sposen Signature Homes.

